

# Clearblue®

## Pregnancy Test

### Rapid Detection

- Over 99% accurate from the day of your expected period.
- **Read this leaflet carefully before taking a test.**

### 1 Before you begin

You may find it helpful to have a watch or clock with you when doing the test.

You can test at any time of the day from the day you expect your period.

### 2 Take the test

When you are ready to test, remove the foil wrapper and take off the cap. Use the test stick straight away.

You can test directly in your urine stream, **or** in a sample of your urine collected in a clean, dry container.

- Hold the colour change tip pointing downwards in your urine stream, **or** in your collected urine sample, as shown, for the full **5 seconds**.
- The colour change tip will instantly turn pink showing that urine is being absorbed. **You must continue to hold the colour change tip in the urine for the full 5 seconds.**



- Keep the colour change tip pointing downwards or lay the test stick flat until you are ready to read the result and a blue line has appeared in the control window.

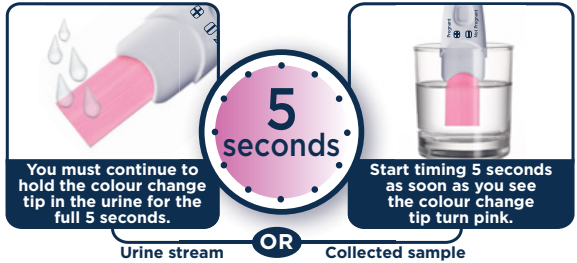

- You may wish to replace the cap.
- If the colour change tip does not turn completely pink see Q5.

**3**  
MINUTES

**WAIT 3 MINUTES.** As the test begins to work you will see blue line(s) start to develop.

### 3 Read your result

You can read your result in the result window.

**A blue line must be present in the control window when you read your result. This line shows that the test has worked.**

A 'Pregnant' result may appear in 1 minute when testing from the day you miss your period (which is the day after your expected period).

You should wait the full 3 minutes to confirm a 'Not Pregnant' result (see Q8).

If you don't see a blue line in the control window the test has not worked (see Q6).

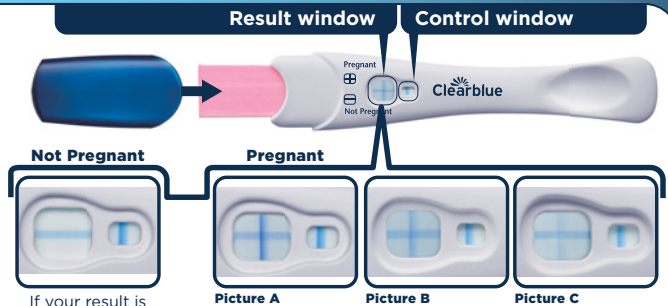

If your result is **'Not Pregnant'** see Q10.

If your result is **'Pregnant'** see Q11.  
If you are still unsure of your result see Q7.

**It does not matter if one of the lines that make up the '+' symbol is lighter or darker than the other; the result is 'Pregnant'.**

**IMPORTANT!** Read your result within **10 minutes** of doing a test. Disregard any changes to your result after this time.

## Questions and Answers

- 1 How accurate is Clearblue?**  
Clearblue is more than 99% accurate in laboratory tests, when used from the day of your expected period.
- 2 How does Clearblue work?**  
When you are pregnant your body produces the pregnancy hormone hCG (human Chorionic Gonadotrophin). The amount of hCG in your body increases in the early stages of pregnancy. Clearblue Rapid Detection can detect tiny amounts of this hormone in your urine (the sensitivity of this test is 25mIU/ml).
- 3 I am not sure when my next period is expected. How do I know I am testing at the right time?**  
To work out when your period is expected, calculate your usual cycle length by counting the number of days from the first day of your period until the day before your next period starts.
  - If you have irregular cycles, you should allow for your longest cycle in recent months before testing.
 If the result is 'Not Pregnant', and pregnancy is still suspected, see Q10.
- 4 Can any medication or medical conditions affect the result?**
  - Always read the manufacturers' instructions for any medication you are taking before conducting the test.
  - Fertility drugs containing hCG can lead to misleading results (these fertility drugs are usually given by injection and testing too soon after administration may give a false 'Pregnant' result).
  - Other fertility therapies (such as clomiphene citrate), painkillers and hormonal contraceptives (e.g. contraceptive pill) should not affect the result.
  - If you have recently stopped using hormonal contraception or are using fertility therapies like clomiphene citrate, your periods may be irregular, leading you to test too soon.
  - If you have recently been pregnant (even if you did not carry to full term) you may get a false 'Pregnant' result.
  - Ectopic pregnancy, ovarian cysts, menopause and some very rare medical conditions can lead to misleading results.
  - If you have a 'Pregnant' result it is possible that you later find that you are not pregnant due to natural loss of the pregnancy which can occur in the early stages.
 If you do get unexpected results you should discuss them with your doctor.
- 5 I have used the pregnancy test but the colour change tip has not turned completely pink. What should I do?**  
If the colour change tip has not turned completely pink you may not have applied enough urine. However, if the blue line in the control window appears within 10 minutes of performing the test then the test has worked. If no blue line appears in the control window within 10 minutes of performing the test, see Q6.
- 6 I have used the pregnancy test but no blue line has appeared in the control window. What should I do?**  
If there is no blue line in the control window within 10 minutes of performing the test, then the test has not worked. This may be because:

- The colour change tip was not kept pointing downwards or the test stick was not laid flat after urine was applied.
  - Too much or too little urine was used. **You must sample for 5 seconds.**
- You should test again, using a new test stick, taking care to follow the instructions. You may wish to collect a sample of your urine in a clean, dry container and immerse only the colour change tip for 5 seconds.
- 7 What if I am unsure of my result?**
    - For your result to be 'Pregnant' there must be a blue line in the control window and a '+' symbol in the result window within 10 minutes of performing the test.
 The appearance of the '+' symbol in the result window may vary, however, the lines that make up the '+' symbol and the line in the control window should be of a similar width (see pictures A-C).
 

**Picture A**  
This is more likely to occur when you are pregnant and you are testing more than a few days after your missed period as hCG levels are higher.







**Picture B**  
This is not unusual when you are pregnant and you are testing on or around the day of your missed period as hCG levels are still relatively low.

**Picture C**  
Even if faint this still denotes a pregnant result.

 If you are still unsure of your result, you should wait at least 3 days before testing again, taking care to follow instructions.
    - For your result to be 'Not Pregnant' there must be a blue line in the control window and a '-' (minus) symbol in the result window within 10 minutes of performing the test.
    - If your result is 'Not Pregnant' and pregnancy is still suspected, see Q10.
  - 8 When can I read the result?**  
A 'Pregnant' result may appear in as fast as 1 minute when testing from the day you miss your period (which is the day after your expected period). Make sure a blue line is also present in the control window before reading your result. **You must** wait 3 minutes to confirm a 'Not Pregnant' result. If no blue line appears in the control window within **10 minutes** the test has not worked (see Q6).
  - 9 How long will the result last?**  
The result can be read any time from 3 to 10 minutes. After 10 minutes any change in your result should be disregarded.
  - 10 My test says I'm 'Not Pregnant'. What should I do?**  
You may not be pregnant, or the level of pregnancy hormone may not be high enough yet to be detected, or you may have miscalculated the day your period was expected.
    - If you tested early, test again when your period is expected.
    - If your period is overdue, test again in 3 days' time. If this test gives you a 'Not Pregnant' result and you still have not had your period, see your doctor.
  - 11 My test says I'm 'Pregnant'. What should I do?**  
If your test says you are pregnant you should see your doctor who can advise you on what steps you should take next.

 **www.clearblue.com**  
**AU 1800 12 50 21 • NZ 0800 27 67 65**  
 Free from landlines, mobiles may be charged. All calls are recorded and may be monitored for quality purposes. Please be ready to quote the **LOT** number.

For next steps, information and general advice relating to issues of pregnancy, visit our website at: [www.clearblue.com](http://www.clearblue.com)

	Manufacturer		Do not re-use
	Batch code		In vitro diagnostic medical device
	Use-by date		Temperature limit 2°C - 30°C

 SPD Swiss Precision Diagnostics GmbH (SPD),  
 Route de St Georges 47, 1213 Petit-Lancy, Geneva, Switzerland.  
 Clearblue is a trade mark of SPD. © 2018 SPD. All rights reserved.  
**TGA Sponsor** KD&A Pty Ltd, 286 Flinders Street,  
 Adelaide, South Australia, 5000, Australia.

For self-testing at home.  
 For *in vitro* diagnostic use only.  
 Not for internal use.  
 Do not reuse.  
 Keep out of reach of children.  
 Store between 2° - 30°C.  
 Allow to reach room temperature for 30 minutes prior to testing if stored refrigerated.  
 Do not use if the foil wrapper is damaged.  
 Do not use after the 'use by' date.  
 Discard with normal household waste.

